

Results Driven Retail Solutions<sup>SM</sup>

**Barnard Commercial**  
Real Estate

# Rockwood Plaza

2330 SE 182nd Ave, Portland OR 97233

This shopping center is located in the Centennial neighborhood of SE Portland on the NE corner of Division and SE 182nd Ave. There is high daily traffic with **31,200 cars per day** on SE 182nd Ave and 20,000 cars per day on Division. This center has **ample parking and great signage.** Major traffic generators include Blackrock Coffee, Planet Fitness, Dollar Tree and Pub 181.



**Available:**

**6,000 SF**

**\$15.00 SF/Year, NNN**

**2,710 SF**

**\$15.00 SF/Year, NNN**

**Approx. \$4.50 NNN**

Craig Barnard | 503.616.2941 | [craig@barnardcommercial.com](mailto:craig@barnardcommercial.com)

Paul Miller | 503.616.2943 | [paul@barnardcommercial.com](mailto:paul@barnardcommercial.com)

[www.barnardcommercial.com](http://www.barnardcommercial.com) | 5200 Meadows Road Suite 150, Lake Oswego OR 97035

All information contained herein was obtained from sources deemed reliable. No guarantee is made with respect to accuracy. Specifications subject to change without notice.

# Rockwood Plaza



**Demographics**

	1 Mile	3 Mile	5 Mile
<b>Population:</b>	20,901	154,581	309,630
<b>Average HH Income:</b>	\$62,587	\$71,934	\$76,285

Craig Barnard | 503.616.2941 | craig@barnardcommercial.com  
 Paul Miller | 503.616.2943 | paul@barnardcommercial.com  
 www.barnardcommercial.com | 5200 Meadows Road Suite 150, Lake Oswego OR 97035

All information contained herein was obtained from sources deemed reliable. No guarantee is made with respect to accuracy. Specifications subject to change without notice.



# Rockwood Plaza

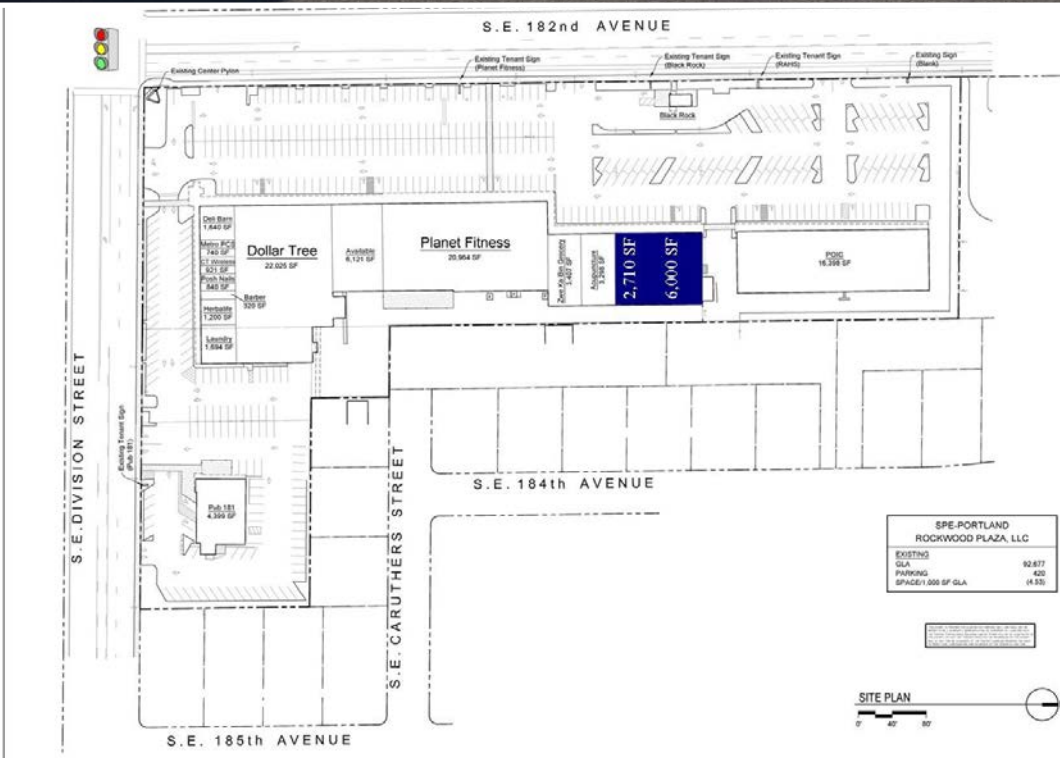

Craig Barnard | 503.616.2941 | craig@barnardcommercial.com  
Paul Miller | 503.616.2943 | paul@barnardcommercial.com

www.barnardcommercial.com | 5200 Meadows Road Suite 150, Lake Oswego OR 97035